

★ DHC250

★ Contactor Data

Main Part No.		DHC250
Contact Data	Contact form	1H (SPST-N0)
	Rated load(Resistive load)	250A
	Min applicable load (Resistive load)	1A/12VDC
	Max switch current	2000A (300VDC) 1 次
	Max switch voltage	1000VDC
	Contact voltage drop(initial)	≤80mV@250A
	Current carrying capacity(a)	250A : continued
		375A: 1h
500A: 20min		
800A: 30s		
Impact resistance	Stability	Half-sine shock pulse:11ms
		Strength
Vibration resistance		10Hz~500Hz 49 m/s ² (> 5G)
Product installation mode		Arbitrarily

Coil Data (20°C)

Coil rated volt.	Pick-up volt.	Release volt.	Max operate volt.	Rated current (±10%)	Rated coil power
12VDC	≤9VDC	≥1VDC	16VDC	Pick-up:2.92A Hold-in:0.375A	Pick-up:35W(0.2s Pick-up) Hold-in:4.5W
24VDC	≤18VDC	≥2VDC	32VDC	Pick-up:1.46A Hold-in: 0.188A	Pick-up:35W(0.2s Pick-up) Hold-in: 4.5W

★ Part Numbering System

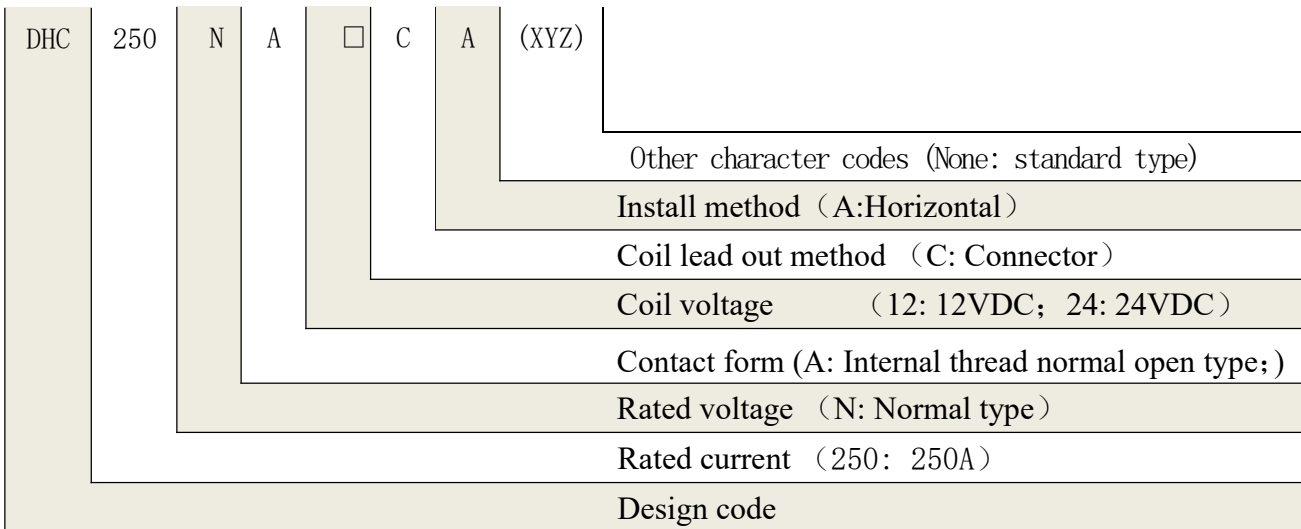

★ Shape installation and circuit diagram

Outline mounting dimension

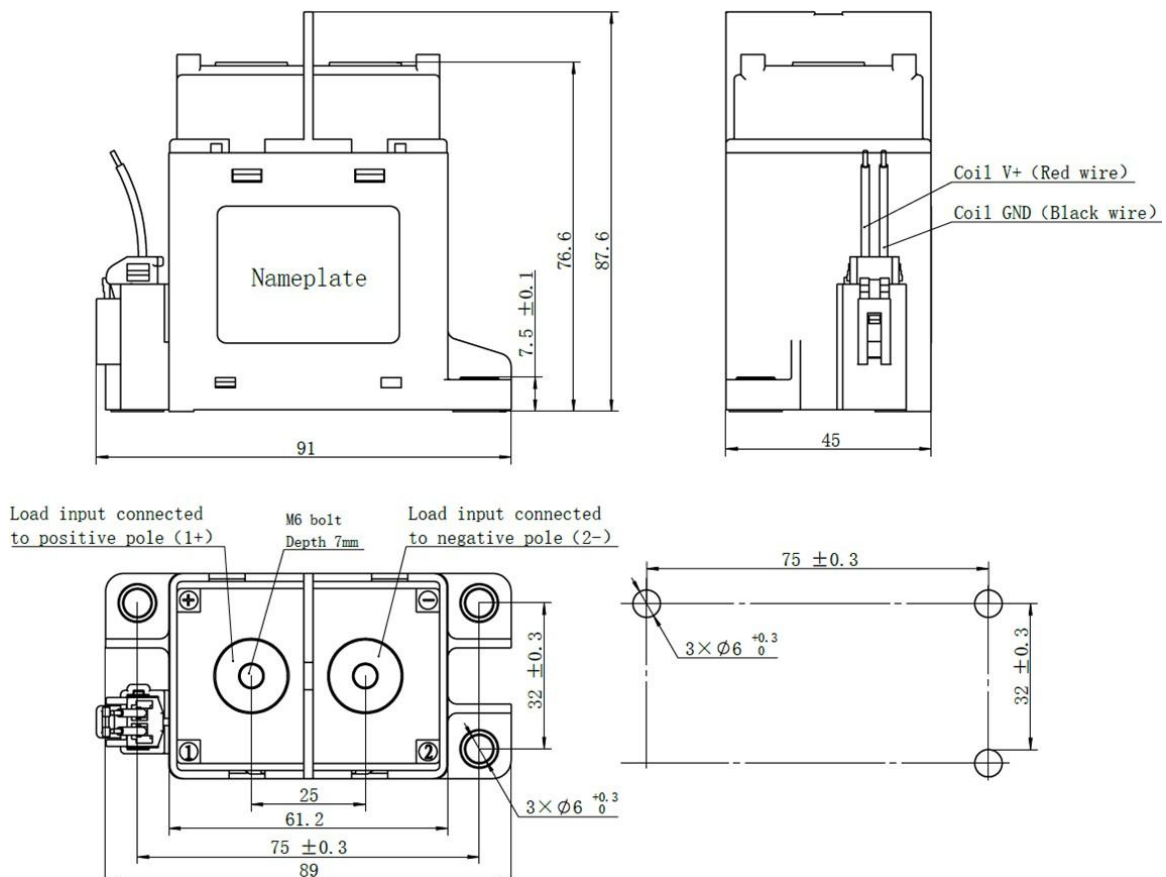

Dimension tolerance	
Tolerance grade not noted	Dimensional tolerance
<10	±0.3
10~50	±0.6
>50	±1

Circuit diagram

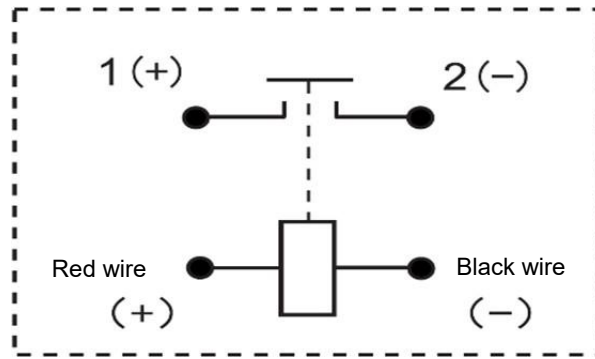

Coil lead out mode (Tianhai: 0435308 or Yazaki: 7283-1020)

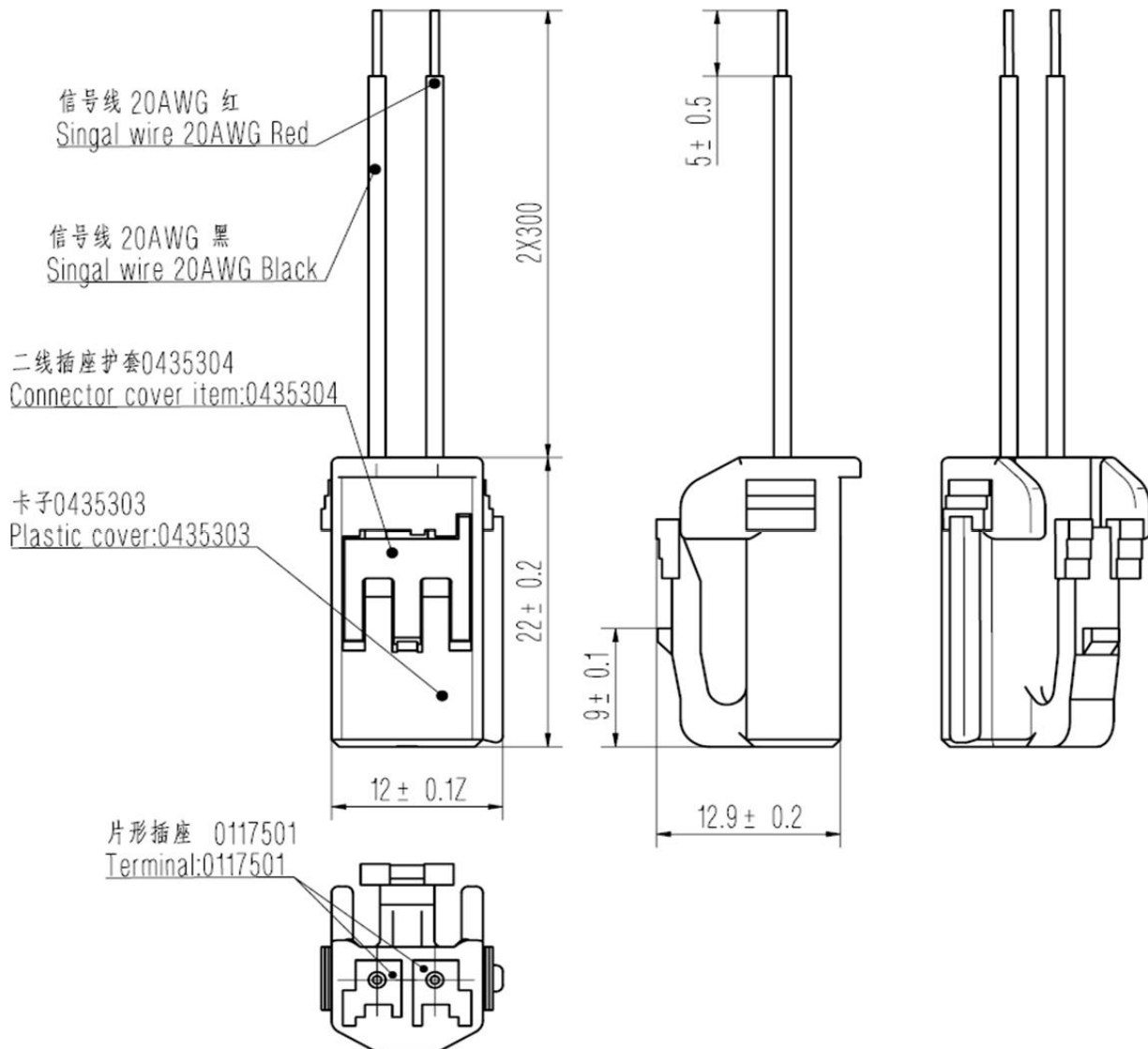

Note: The main contact connect “+” polarity to the main contact terminal with “1+” mark, and connect “-” polarity to the main contact terminal with “2-” mark.

★ Current tolerance curve

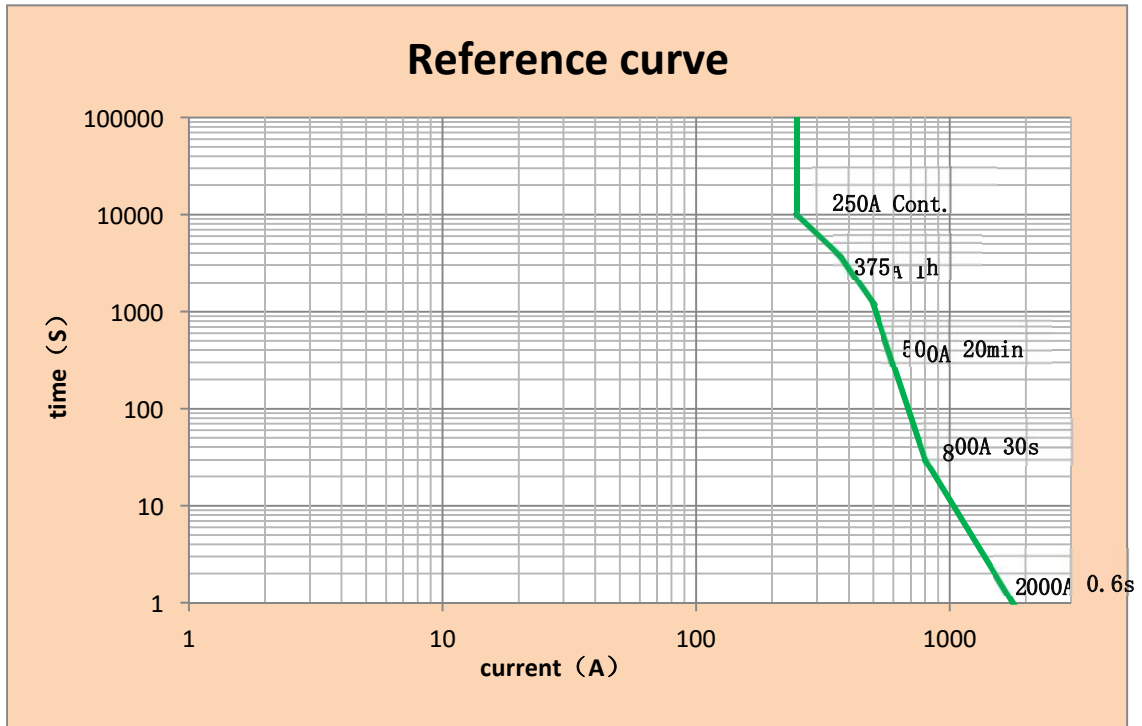

► Note: The above data is tested at 85°C ambient temperature, Traverse area ≥ 95mm². The data is for reference only, please do not use to select the fuse directly.

★ Electrical life curve

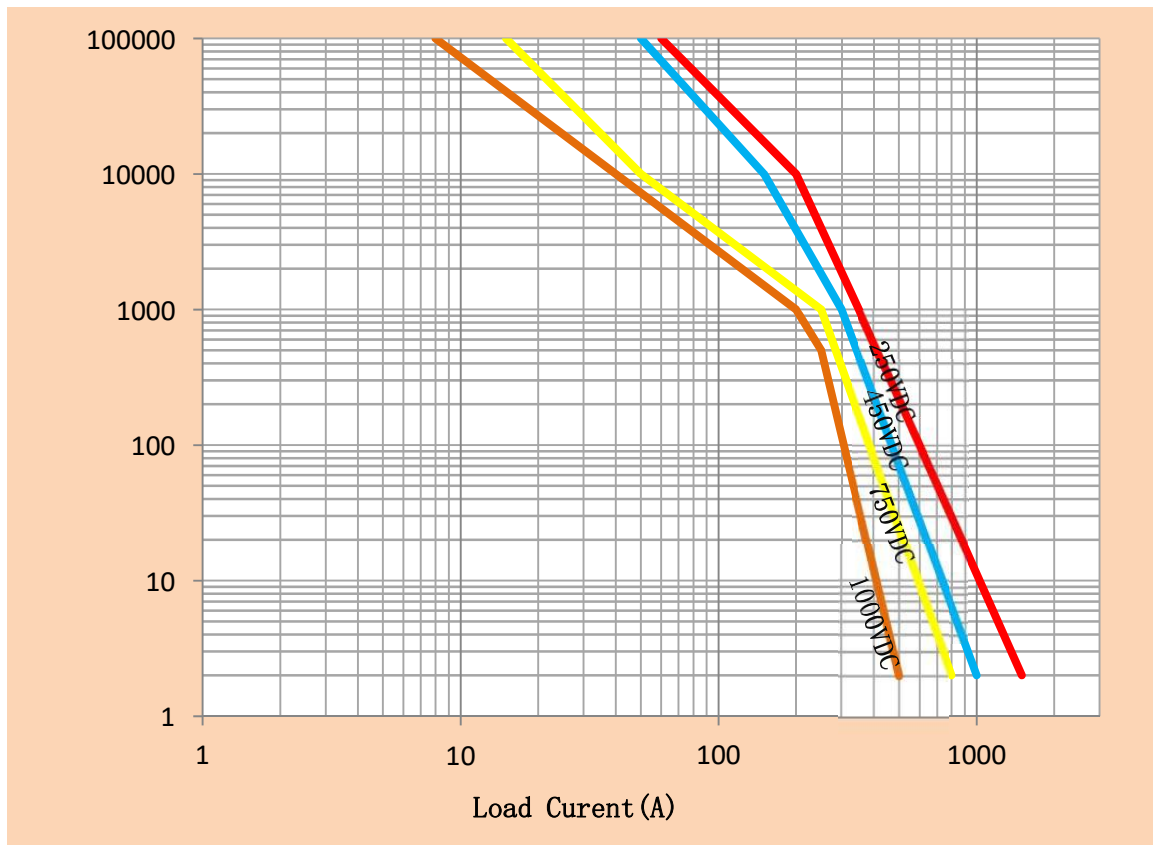

★ Pick-up / release voltage curve

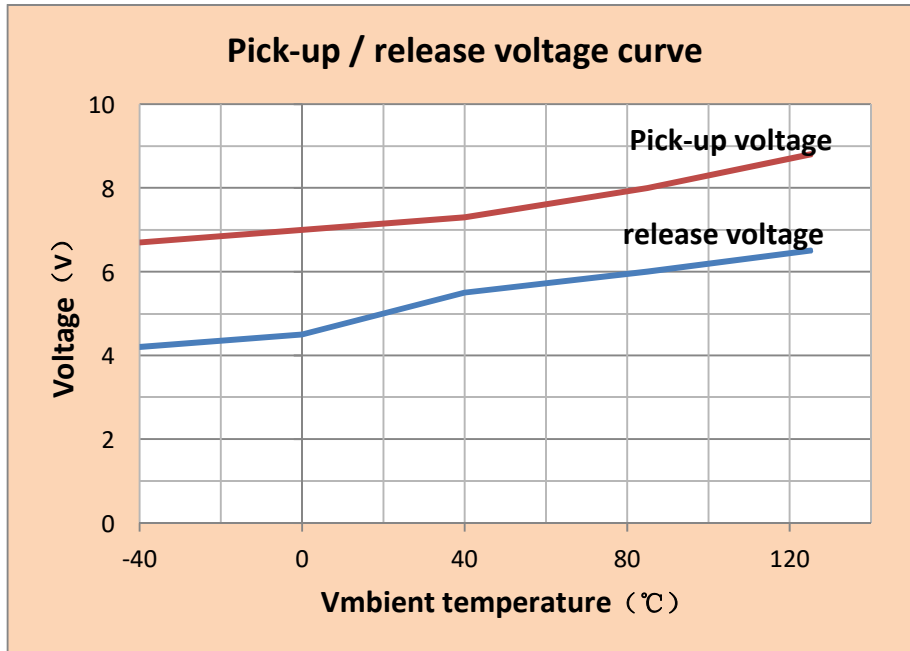

- ▶ The above data are tested by random sampling of coil volt. 12VDC product. The data is for reference only, (test qty:n=3)