



DONGYA ELECTRONIC



ZLJM-125D

Series contactors 系列 接触器

1.1 线路原理图 Circuit diagram

ZLJM-125D/1
—带常开型(SFSTN(C))
带微动开关(With Microswitch)
3, 4为触点接线端(3, 4 contact terminal)
1, 2为线圈接线端(1, 2 coil terminal)
L为线圈(L is winding)

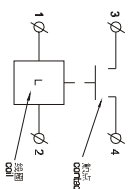

ZLJM-125D/1D
—带常开型(SFSTN(C))
带微动开关(With Microswitch)
3, 4为触点接线端(3, 4 contact terminal)
1, 2为线圈接线端(1, 2 coil terminal)
L为线圈(L is winding)

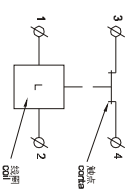

ZLJM-125D/1Z
—带常开型(SFSTN(C))
带微动开关(With Microswitch)
3, 4, 5, 6为触点接线端
(3, 4, 5, 6 contact terminal)
1, 2为线圈接线端(1, 2 coil terminal)
L为线圈(L is winding)

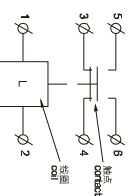

ZLJM-125D/1 · S
—带常开型(SFSTN(C))
带微动开关(With Microswitch)
3, 4为触点接线端(3, 4 contact terminal)
1, 2为线圈接线端(1, 2 coil terminal)
L为线圈(L is winding)
A, B, C, D为辅助触点接线端
(A, B, C, D aux.contact terminal)

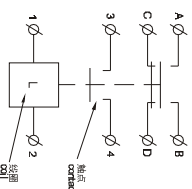

ZLJM-125D/1D · S
—带常开型(SFSTN(C))
带微动开关(With Microswitch)
3, 4为触点接线端(3, 4 contact terminal)
1, 2为线圈接线端(1, 2 coil terminal)
L为线圈(L is winding)
A, B, C, D为辅助触点接线端
(A, B, C, D aux.contact terminal)

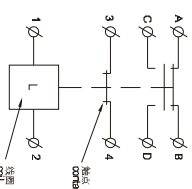

ZLJM-125D/1Z · S
—带常开型(SFSTN(C))
带微动开关(With Microswitch)
3, 4, 5, 6为触点接线端
(3, 4, 5, 6 contact terminal)
1, 2为线圈接线端(1, 2 coil terminal)
L为线圈(L is winding)
A, B, C, D为辅助开关接线端
(A, B, C, D aux.contact terminal)

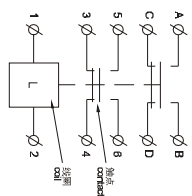

1.2 产品型号含义 Nomination(nomogram)



1.3 使用条件 Use conditions required

- 环境温度 Ambient temperature: -25~+40℃
- 相对湿度 Relative humidity: +20℃±98%(up to 98% at +20℃)
- 相对湿度 Relative humidity: +20℃±98%(up to 98% at +20℃)
- 固定外的振动频率 Vibration freq. at the fixed position:
 - 3g, 1~50Hz 振幅 0.5mm
 - 3g, 1~50Hz 振幅 0.5mm
- 安装方向 Mounting directions: 任意 Optional

1.4 简要技术数据 Basic technical data

序号 NO.	参数名称 Parameters	产品代号 Product code
1	线圈额定电压 Rated coil volt(V/DC)	ZLJM-125D系列 series
2	线圈功耗 Coil Power dissipation(W)	12, 24, 30, 48, 60, 72, 120等(etc)
3	触点电路额定电压 Rated volt. of contact circuit(V/DC)	8-13
4	触点电路额定负载电流 Rated load current of contact circuit(A)	60
5	触点电路额定电压 Rated volt. of contact circuit(V/DC)	125A
6	额定电压下最大动作时间(Max. operating time at rated volt)(ms)(线圈不带抑制电路)(Coil with no suppression circuit)	不大于线圈额定电压的70% Not above 70% of rated coil volt
7	抗电强度 Puncture(volt)/strength	释放 Release 线圈额定电压的(5-30)% (5-30% of rated coil volt)
8	额定负载下触点接触压降 Rated load current of contact circuit	30
9	电寿命 Electric life	50Hz 1000V AC 1min 不大于80mV no. above 80mV
10	机械寿命 Mechanical life	20,000 Ops
11	工作规范 Working duty	10万次 100,000 Ops. 连续 Continuous

外形安装图
Configurational mounting diagram

125D外型安装图
125D Configurational mounting diagram

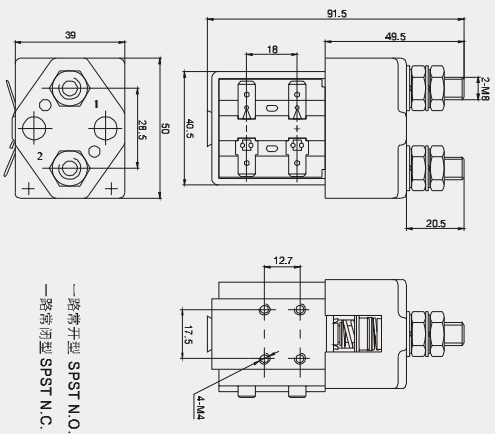

一路常开型 SPST N.O.
一路常闭型 SPST N.C.

带微动开关WDK-1和安装支架外形安装图
with microswitch WDK-1 and mounting bracket configurational mounting diagram

125D安装外型安装图
125D mounting bracket configurational mounting diagram

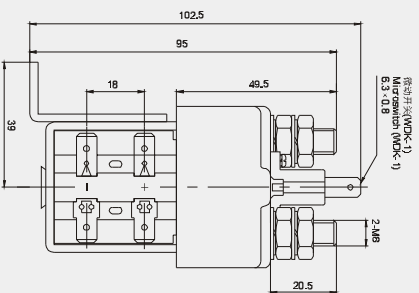

安装方式一
The first mounting method

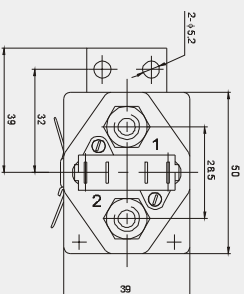

125 1Z外型安装图
125 1Z Configurational mounting diagram

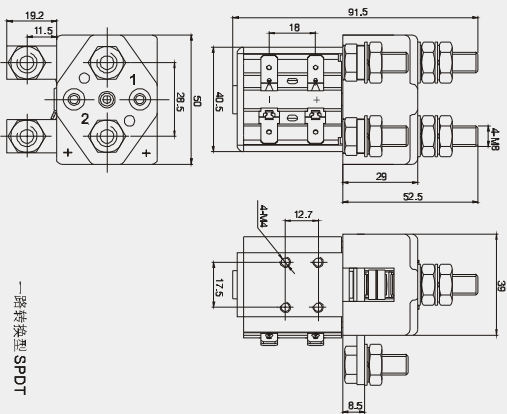

一路转换型 SPDT

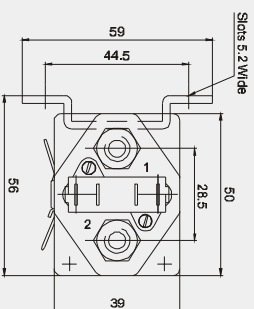

安装方式二
The second mounting method

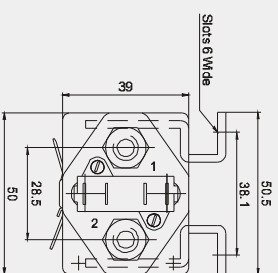

安装方式三
The third mounting method